

The background is a vibrant yellow. It is decorated with several abstract geometric shapes in shades of blue, teal, and white. These include circles, semi-circles, and rounded rectangular shapes, some of which are layered or overlapping. The shapes are scattered across the page, with a concentration in the top right and bottom left corners.

Appendix A14.1
Scheme Walkover
Summary

Contents

Appendix A14.1: Scheme Walkover Summary 1

1.1 Introduction 1

1.2 Summary 2

1.3 Photos..... 4

Appendix A14.1: Scheme Walkover Summary

1.1 Introduction

The following is a summary of the observations by the Land, Soils, Geology and Hydrogeology Environmental Impact Assessment Team following a physical walkover of the Ballymun / Finglas to City Centre Core Bus Corridor Scheme (hereafter referred to as the Proposed Scheme). The walkover occurred on 7 February 2020 and 9 July 2021.

Not all observations have been included in this summary for conciseness. Typically, only observations that could not have been determined from a desk study and that are relevant to Chapter 14 (Land, Soils, Geology & Hydrogeology) in Volume 2 of this Environmental Impact Assessment Report (EIAR) have been included. The omission of an observation or a feature does not negate the feature's importance in terms of the land, soils, geology and hydrogeology environmental impact assessment.

The observations are summarised in Table 1 and the corresponding photos in Table 2 of this Appendix.

1.2 Summary

Table 1: Scheme Walkover Summary

Observation	General Arrangement Drawing Sheet Number*	Description	Possible Impact	Photo Number
Phibsborough Road	16	Retaining walls were noted along this section of the route. It may require minor level changes, construction of a new retaining wall and earthworks to accommodate the works.	This may pose an issue for the earthworks balance and waste assessment.	Ballymun_Image01
Royal Canal Bank	13	Widening road in area where old canal may have been and subsequently infilled, new proposed cycle bridge to be constructed across the canal. Possible source of contamination.	This may pose an issue for the earthworks balance and waste assessment and mobilising contaminants into the groundwater.	Ballymun_Image02 & 03
Bequileme Bridge	13	Significant earthworks will be required to create an underpass under the existing bridge. The composition of the fill surrounding the bridge is unknown.	This may pose an issue for the earthworks balance and waste assessment and mobilising contaminants into the groundwater.	Ballymun_Image04
St. Mobhi Road widening	08 - 10	Retaining walls were noted along this section of the route. It may require minor level changes, construction of a new retaining wall and earthworks to accommodate the works.	This may pose an issue for the earthworks balance	Ballymun_Image05
Cycle track and proposed location of construction compound B2 along the River Tolka	10	Minor level changes were noted across the area, this may require minor earthworks to accommodate the works. This is also the location of a potential construction compound.	This may pose an issue for the earthworks balance and waste assessment and mobilising contaminants into the groundwater	Ballymun_Image06
Petrol Stations	Various	Historic activities at petrol stations may have resulted in oil leaks into the surrounding soils and groundwater in the past.	This may pose an issue for the earthworks balance and waste assessment and mobilising contaminants into the groundwater.	Ballymun_Image07
Proposed Metro Station – Northwood Avenue	Sheet 01, 03, 06, 10 & 13.	The maps indicate that proposed metro stations may be located at Northwood Avenue, Santry Cross, Ballymun Civic Centre, St Mobhi Road and Griffith Park.	The overlap is not known at this time.	Ballymun Image 05, 08 & 10
Proposed Construction Compound B1 at Santry Cross	20	A proposed construction compound is to be located at Santry Cross. Minor level changes were noted across the green area and topsoil will likely be stripped to accommodate the works.	This may pose an issue for the earthworks balance and waste assessment.	Ballymun Image 09

Observation	General Arrangement Drawing Sheet Number*	Description	Possible Impact	Photo Number
Proposed Construction Compound B3 at Constitution Hill/ Catherine Lane North	20	A proposed construction compound is to be located at Catherine Lane North. This location is situated within an urban environment. Topsoil was noted within the site and level changes were noted on the perimeter of the site and may require the removal of boundary walls in order to access the location.	This may pose an issue for the earthworks balance and waste assessment.	Ballymun Image 11
Bachelors Stream adjacent to Finglas Road	11	The Bachelors Stream runs adjacent to the route. It was inaccessible at the time of the site walkover and is bounded by vegetation in this area.	This may pose an issue for mobilising contaminants into the groundwater and River Tolka downstream.	Screen grab from Google Imagery as inaccessible during walkover
Glasnevin Cemetery	12-14	The maps indicate that the road is to be widened near Glasnevin Cemetery. Minor level changes were noted in the green area across the road from the main cemetery and will likely require minor earthworks to accommodate the works.	This may pose an issue for the earthworks balance and waste assessment.	Finglas_Image01
Proposed Construction Compound at F1 at Casement Road.	01	A proposed construction compound is to be located at Casement Road, topsoil strip and minor earthworks may be required to accommodate the works.	This may pose an issue for the earthworks balance and waste assessment.	Finglas Image 02
Proposed Construction Compound F2 at Finglas Road / Finglas Place	06	A proposed construction compound is to be located at Finglas Road / Finglas Place. Minor level changes were noted in the grass verge and will likely require minor earthworks to accommodate the works.	This may pose an issue for the earthworks balance and waste assessment.	Finglas Image 03
Proposed Construction Compound F3 at Claremont Lawns, Glasnevin Cemetery	14	A proposed construction compound is to be located at Claremont Lawns. Minor level changes were noted in the grass area and will likely require minor earthworks to accommodate the works.	This may pose an issue for the earthworks balance and waste assessment.	Finglas_Image04

1.3 Photos

Table 2: Scheme Walkover Photos

Photo ID	Caption	Date Taken	Coordinates
Ballymun_Image01	Level change and retaining wall – Phibsborough Road	7/2/2020	714926, 735257 (ITM)



Key plan

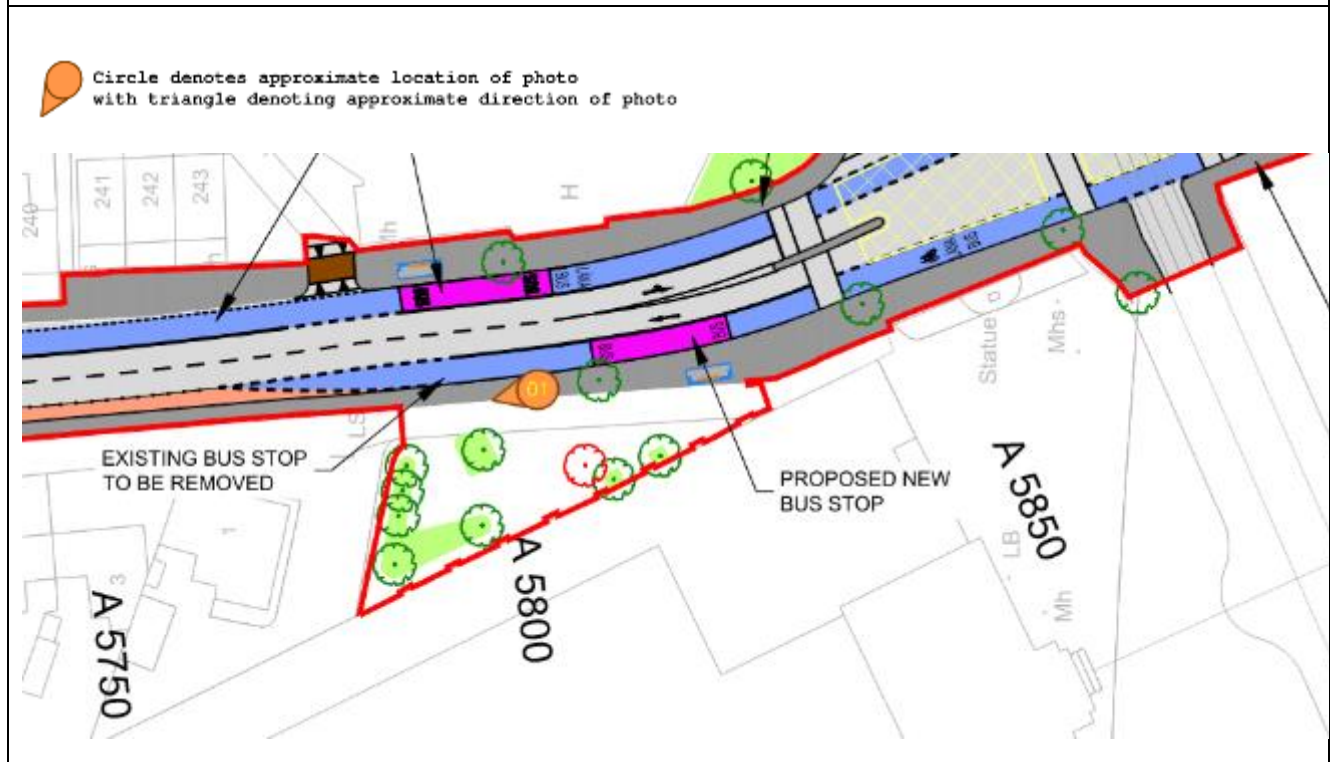



Photo ID	Caption	Date Taken	Coordinates
Ballymun_Image03	Proposed location for a new cycle bridge across the canal	07/02/2020	715086, 376255 (ITM)



Key plan

 Circle denotes approximate location of photo
 with triangle denoting approximate direction of photo

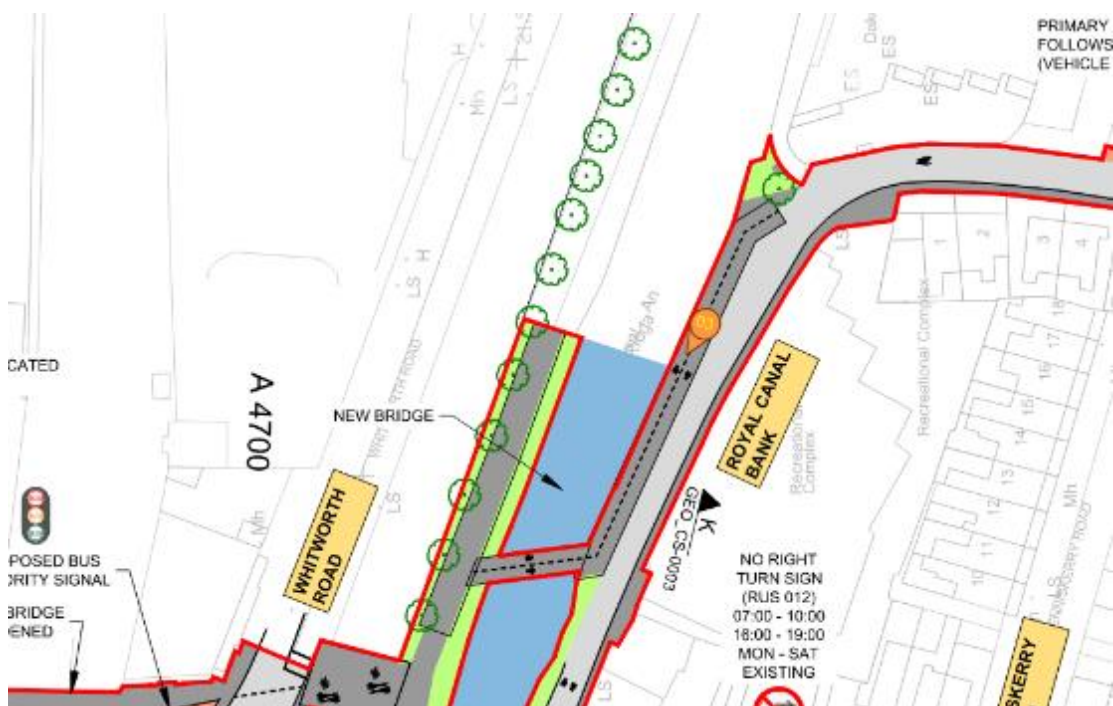

Photo ID	Caption	Date Taken	Coordinates
Ballymun_Image04	New underpass under Blacquiere bridge where the old canal was infilled	07/02/2020	714967, 735972 (ITM)



Key plan



 Circle denotes approximate location of photo
 with triangle denoting approximate direction of photo



Photo ID	Caption	Date Taken	Coordinates
Ballymun_Image05	Mobhi Road Widening	07/02/2020	715429, 737288 (ITM)



Key plan

 Circle denotes approximate location of photo
 with triangle denoting approximate direction of photo

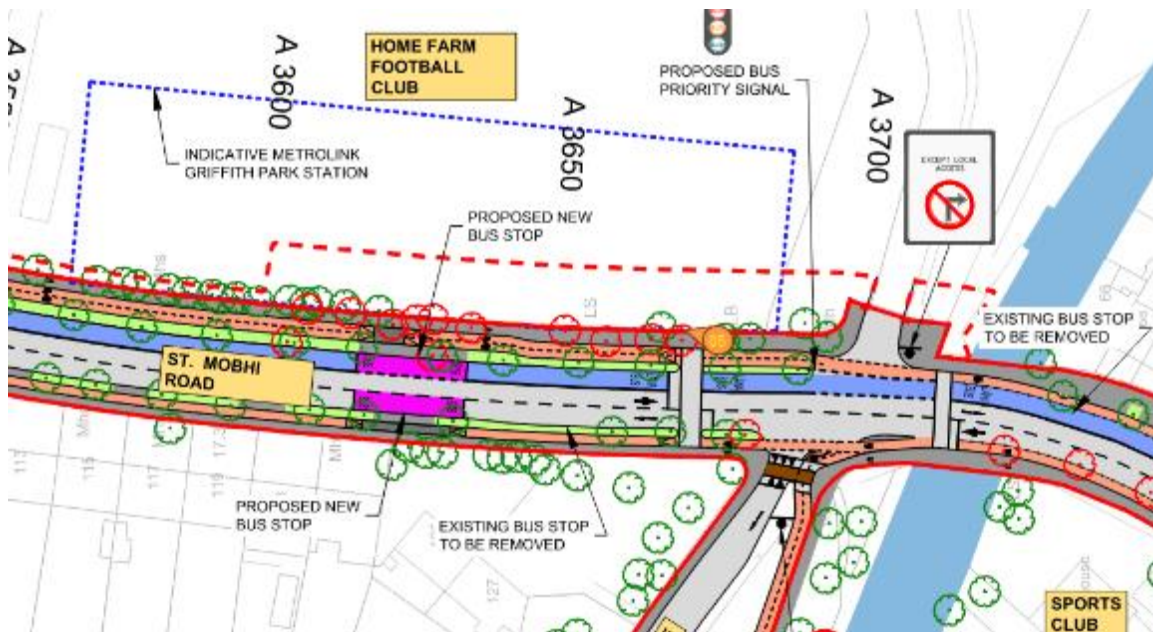

Photo ID	Caption	Date Taken	Coordinates
Ballymun_Image06	Cycle track and location of proposed construction compound along the River Tolka	07/02/2020	715369, 737242 (ITM)



Key plan



 Circle denotes approximate location of photo
 with triangle denoting approximate direction of photo



Photo ID	Caption	Date Taken	Coordinates
Ballymun_Image07	Petrol stations	07/02/2020	715251, 738334 (ITM)



Key plan

 Circle denotes approximate location of photo
 with triangle denoting approximate direction of photo

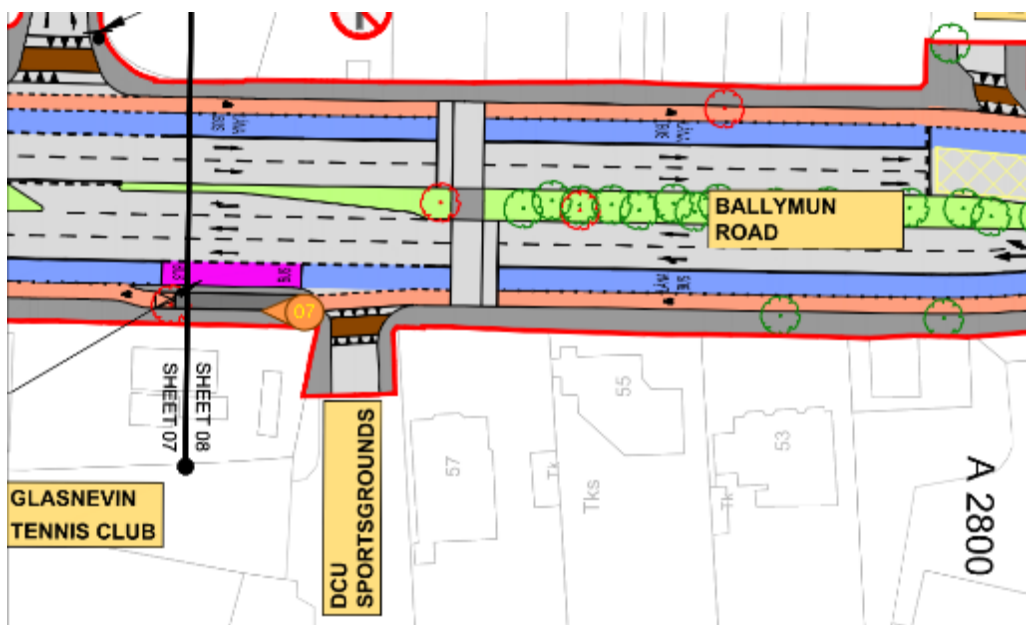



Photo ID	Caption	Date Taken	Coordinates
Ballymun_Image08	Image of proposed location for metro station at Northwood Avenue.	09/07/2021	715402, 740751 (ITM)



Key plan

 Circle denotes approximate location of photo with triangle denoting approximate direction of photo

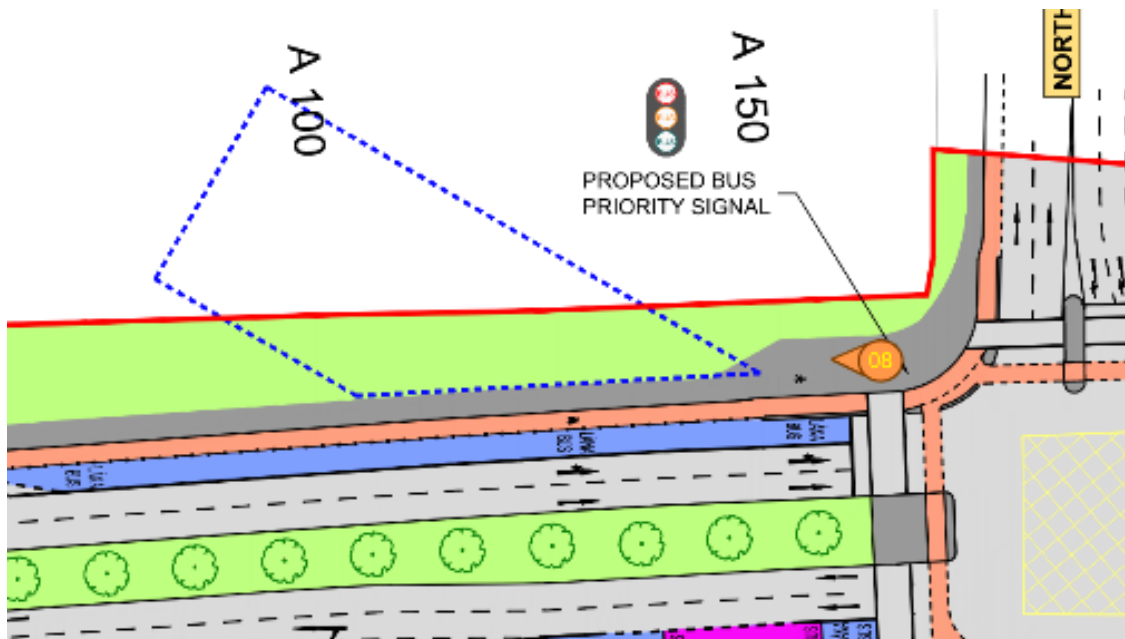

Photo ID	Caption	Date Taken	Coordinates
Ballymun_Image09	Image of proposed location for construction compound B1 at Santry Cross.	09/07/2021	715418, 740423 (ITM)



Key plan

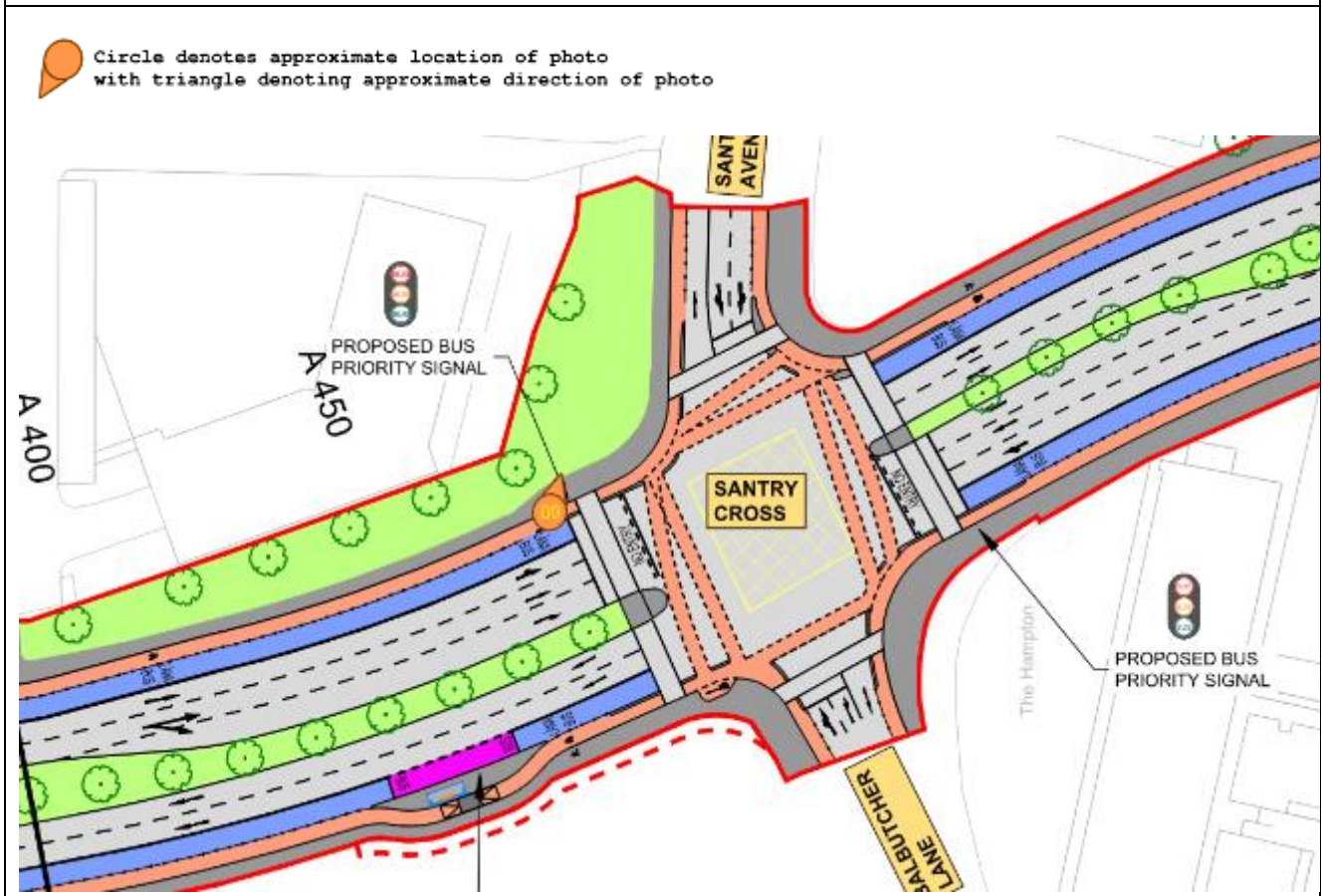

Photo ID	Caption	Date Taken	Coordinates
Ballymun_Image10	Image of proposed location of metro station at Ballymun Civic Centre.	09/07/2021	715436, 739642 (ITM)



Key plan

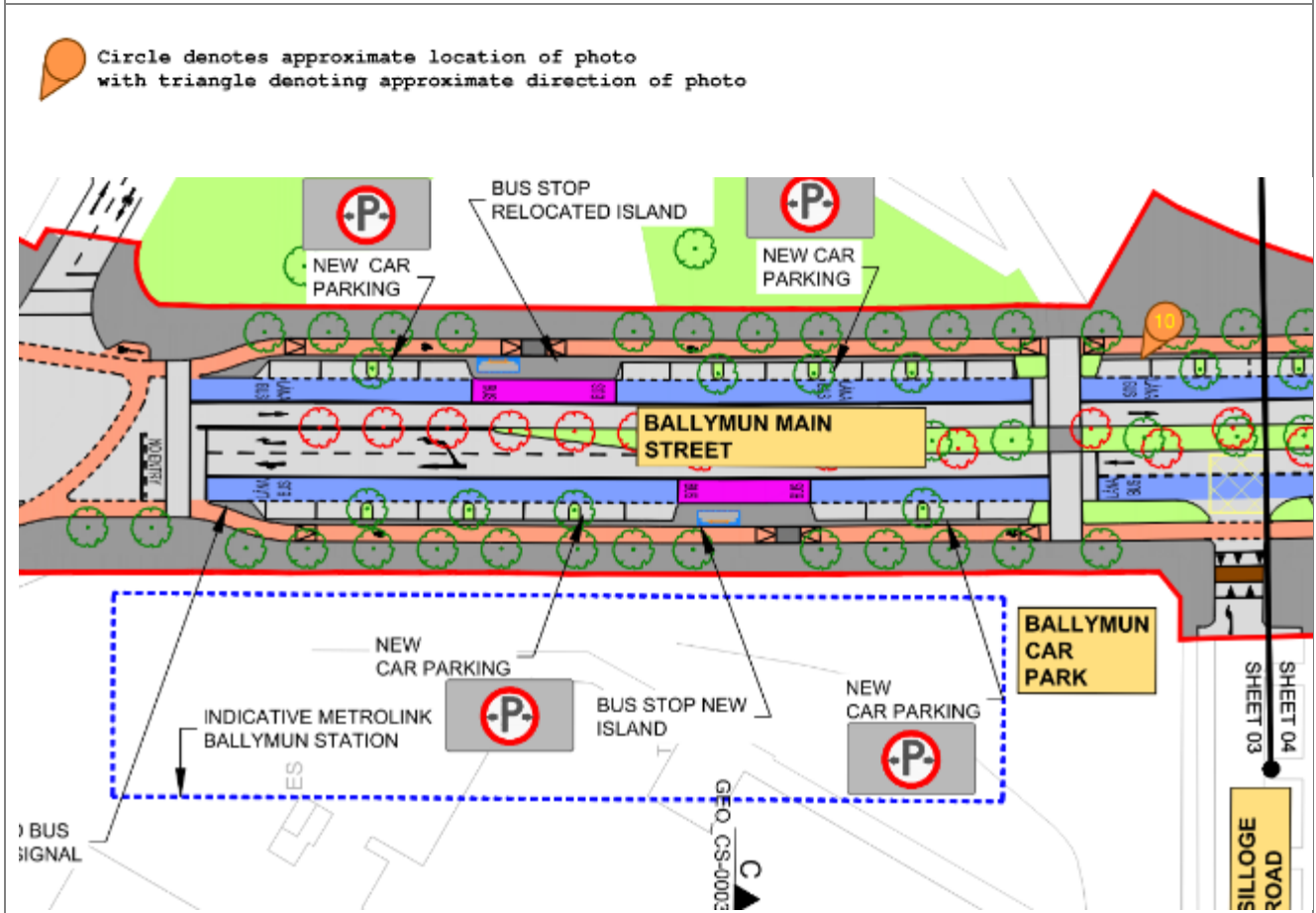

Photo ID	Caption	Date Taken	Coordinates
Ballymun_Image11	Image of proposed location of a construction compound at Constitution Hill/ Catherine Lane North Junction	09/07/2021	714896, 734888 (ITM)



Key plan

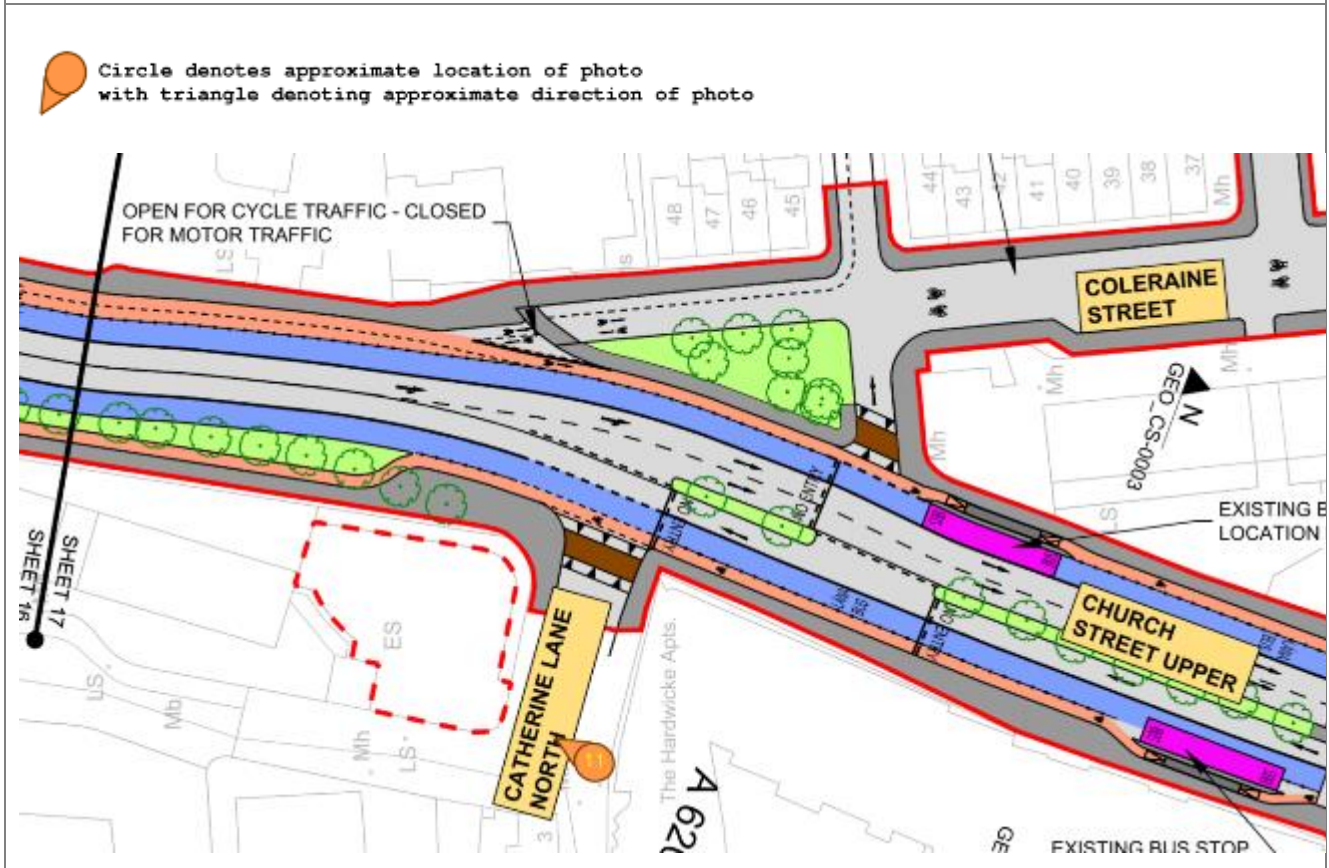



Photo ID	Caption	Date Taken	Coordinates
Screen grab from Project Drone Imagery as inaccessible during walkover	Bachelors Stream adjacent to Finglas Road	07/02/2020	713916, 737967



Key plan

 Circle denotes approximate location of photo
 with triangle denoting approximate direction of photo

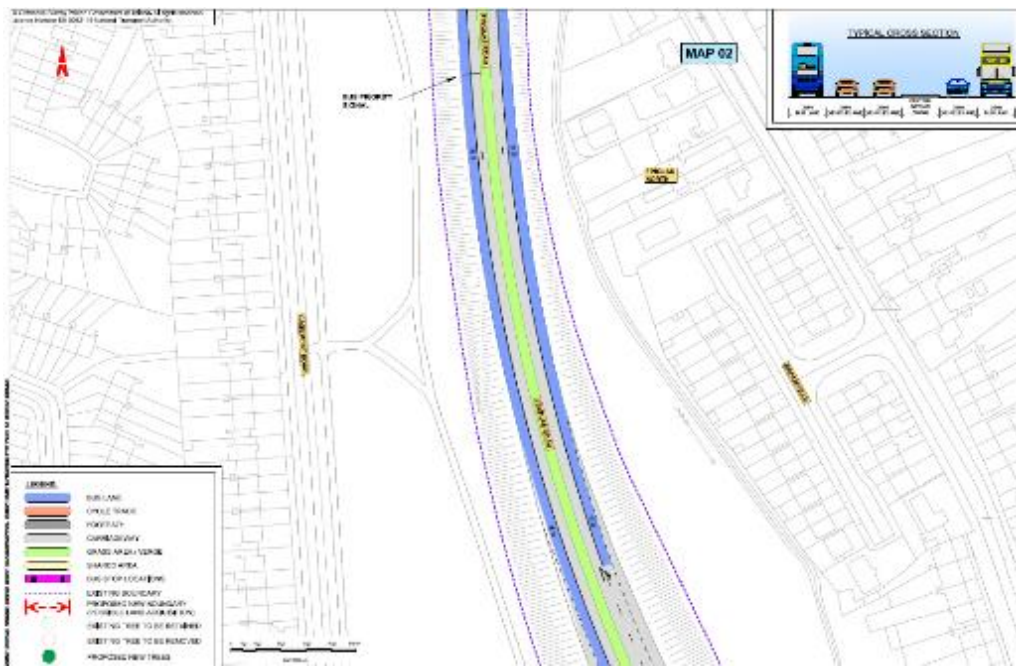

Photo ID	Caption	Date Taken	Coordinates
Finglas_Image01	Glasnevin Cemetery	07/02/2020	714616, 736829 (ITM)



Key plan

 Circle denotes approximate location of photo
 with triangle denoting approximate direction of photo



Photo ID	Caption	Date Taken	Coordinates
Finglas_Image02	Image of proposed location for a construction compound F1 at Casement Road.	09/07/2021	712679, 739543 (ITM)



Key plan



 Circle denotes approximate location of photo
 Triangle denoting approximate direction of photo



Photo ID	Caption	Date Taken	Coordinates
Finglas_Image03	Image of proposed location for a construction compound F2 at Finglas Place.	09/07/2021	713408, 738607 (ITM)



Key plan

 Circle denotes approximate location of photo
 with triangle denoting approximate direction of photo



Photo ID	Caption	Date Taken	Coordinates
Finglas_Image04	Image of proposed location for construction compound F3 at Claremont Lawns – Glasnevin Cemetery.	09/07/2021	714549, 736877 (ITM)



Key plan



Circle denotes approximate location of photo
 with triangle denoting approximate direction of photo

